

T H E G R A C E F U L L I V I N G . . .



Shree Tirumala

Nandan



2 & 3 BHK HOMES



Shree Tirumala
Nandan

2 & 3 BHK HOMES

Not only the elite location,
But the place where you live in also a compliment.
Your status & dignity own your prestigious address at
"SHREE TIRUMALA NANDAN" today.



Roongta GroupTM
Builders & Developers
INNOVATING... CREATING... TRANSFORMING

Welcomes you in Roongta Group FAMILY.

The ROONGTA GROUP was established in 1996, in response to the growing need for quality housing and commercial properties. Since then, the Group has completed various Commercial & Residential projects and the Group has grown to be one of the leading real Estate Developers, serving the needs of a discerning clientele. Today, the group has an enviable reputation for providing innovative design, quality construction, clear legal title and timely possession.

Good Living Lifestyle
It gives us a great pride and satisfaction to welcome you to a few of our illustrious projects. You will find the Location.. the Amenities.. the Design.. everything about them, totally satisfying.

You have chosen your home with care, and we have built it with care, and that commitment does not end when you move in to your new home. Our commitment to creating spaces for families to do the work of creating life, goes beyond the mechanics of building your new home, to a strong focus on service to our clients. At Roongta Group, we will continue to journey with you through your first year of living in your new home, to ensure that quality and workmanship are maintained, and that you have access to answers to any questions that may come up.

The policy of the company is "To deliver the customer well designed Accommodation along with Super Luxurious Amenities".

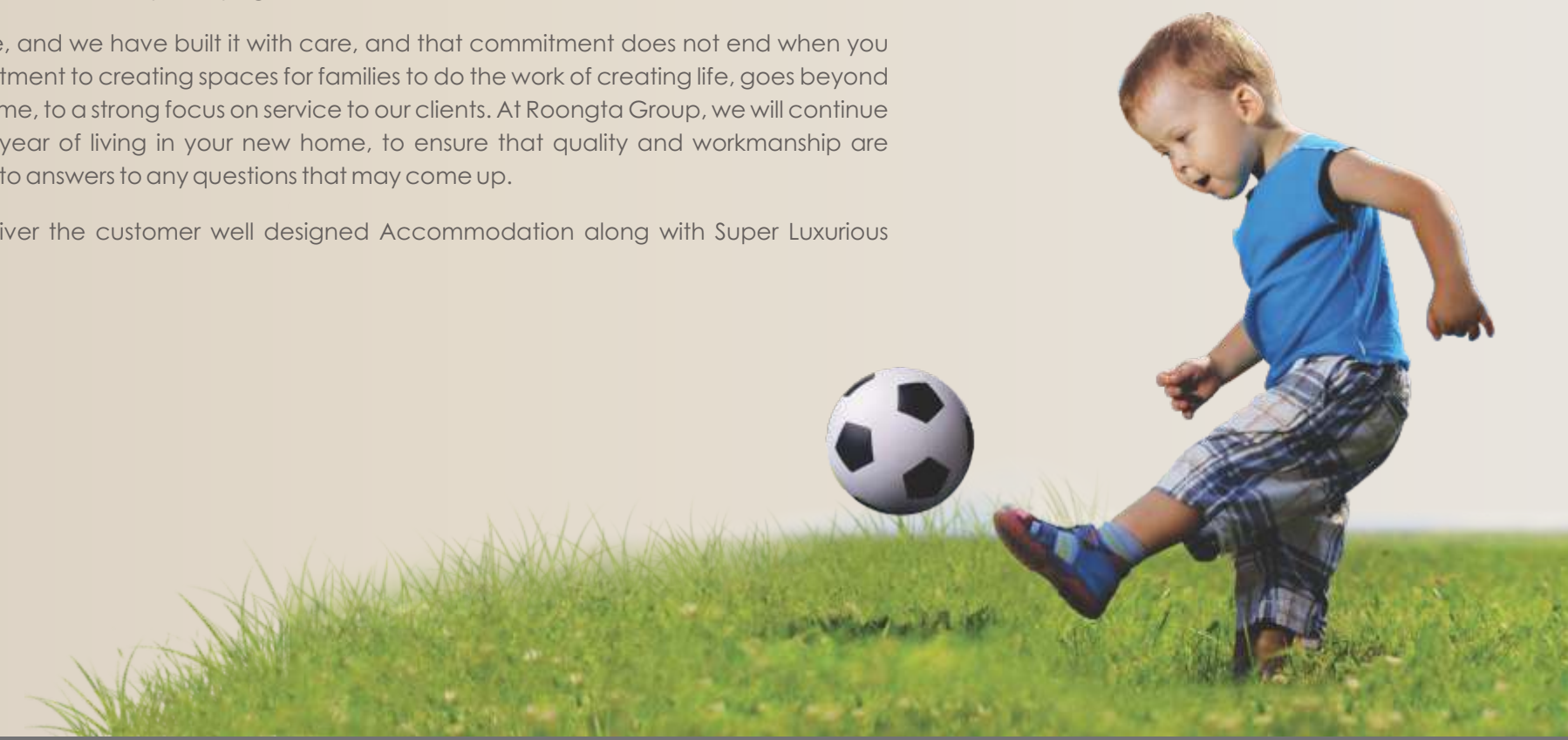

Kids Play Area



Open Gymnasium



Indoor Games



Artificial Lawn

AMENITIES

- Structure** : R.C.C. Frame structure, External wall 6" thick and internal wall 4" thick Block.
- Plaster** : External Sandfaced & Internal neeru finish Plaster.
- Paint** : Internal oil bound distemper. External waterproof Apex paint.
- Doors** : Laminated doors with attractive fittings.
- Windows** : Three track aluminium powder coated sliding windows with Mosquito Net, Safety Grills & Granite Frames.
- Kitchen** : Granite kitchen platform 10' with stainless steel sink. Ceramic tile dado above Kitchen platform.
- Bath / Toilets** : Concealed plumbing with hot / cold mixer system. Branded toilet fittings, Designer glazed tile upto 7' and anti-skid tiled floor. Provision for geyser.
- Flooring** : Vitrified 2x2 tiles. Terrace floor to be in rustique ceramic tiles.
- Electrification** : Concealed electrification. Adequate number of point of Light, Fan and Plug points. AC Point in master bedroom. Leon/Anchor Roma or equivalent modular switches.
- Parking** : Paved with chequered tiles.
- Specification** : • Lift with battery backup • Reserved Car Parking

GROUND / PARKING FLOOR



*Subject to availability of space for parking

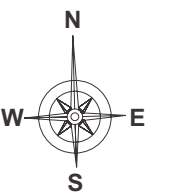



1097.00 sq.ft.
(101.95 sq.mtr.)

**A - Wing
FIRST FLOOR PLAN**



1070.00 sq.ft.
(99.44 sq.mtr.)

**A - Wing
TYPICAL FLOOR PLAN
2nd, 3rd & 4th Floor**

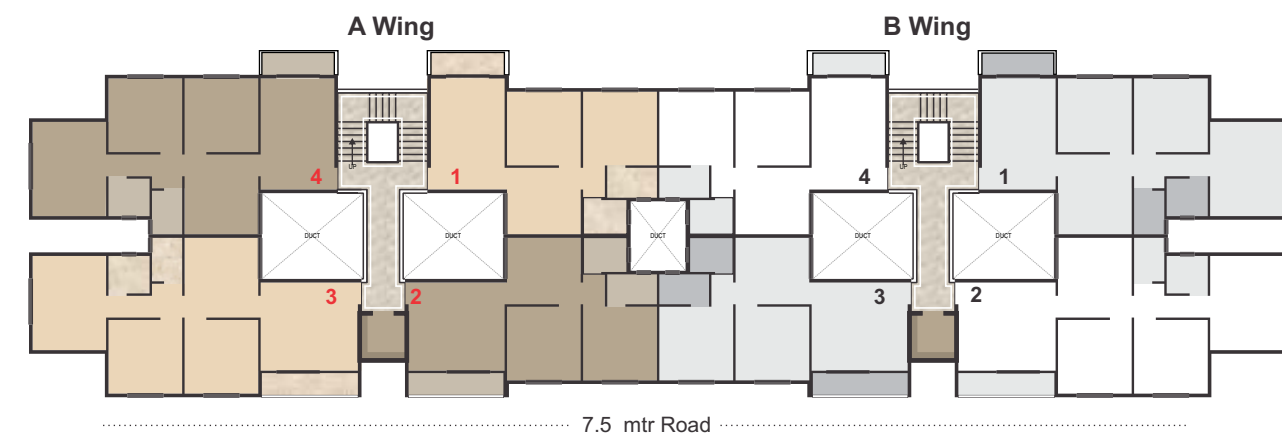
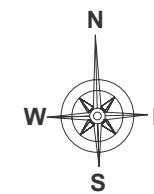

KEY PLAN

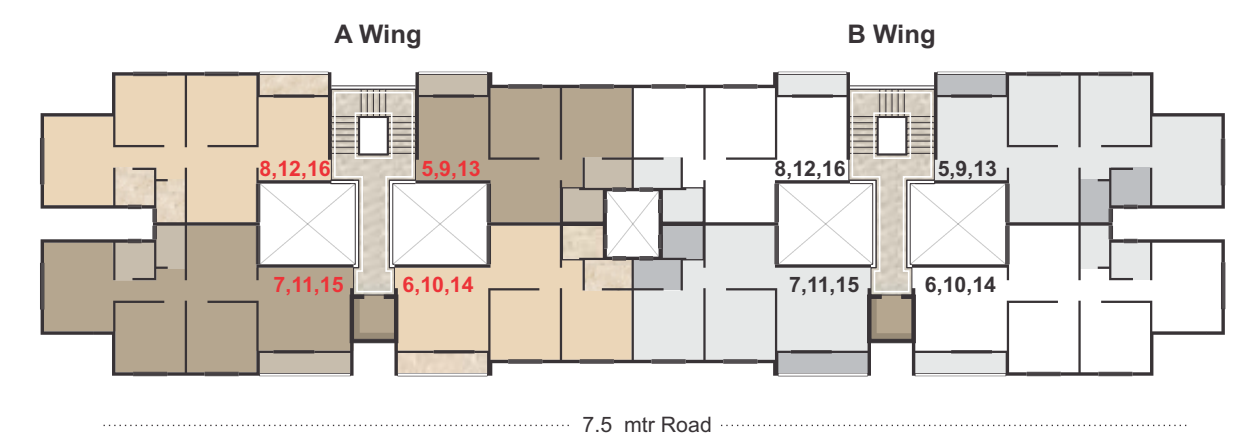
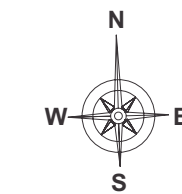

KEY PLAN



**B- Wing
FIRST FLOOR PLAN**



**B- Wing
TYPICAL FLOOR PLAN
2nd, 3rd & 4th Floor**

1070.00 sq.ft.
(99.44 sq.mtr.)

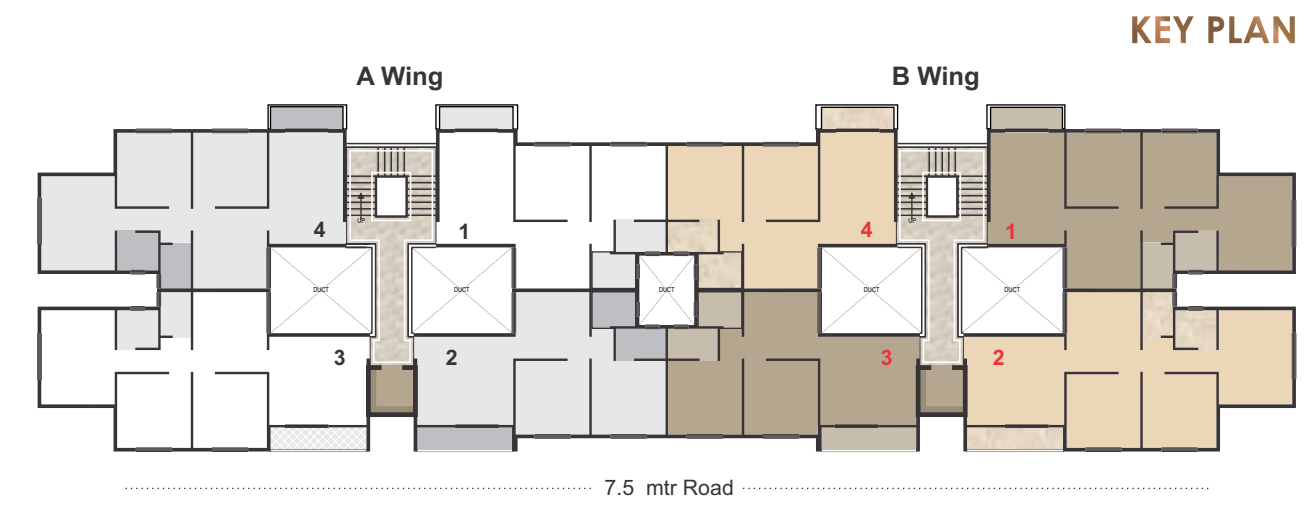
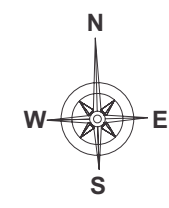

KEY PLAN

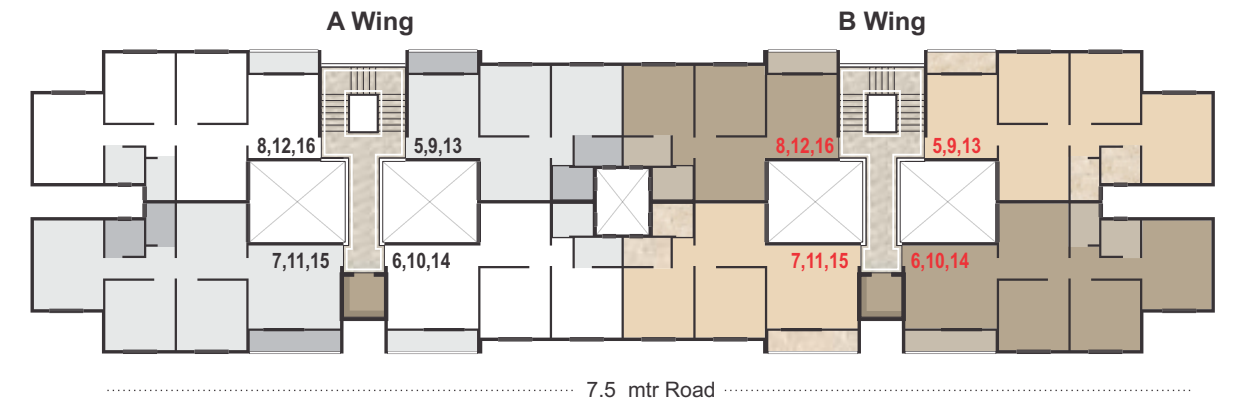
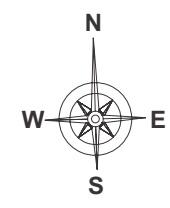

KEY PLAN

TERRACE FLOOR PLAN

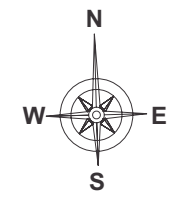

Note : The information contained in this brochure such as the plans, specification, images and other details herein are indicative only. The Developer reserves the rights to change any or all of these.



Garden style that finds elegance in simplicity...



Corporate Office :
 Shree Tirumala Ashirwad Apt.,
 Pethe Nagar Road (Indira Nagar),
 Opp. Bal Bharti, Nashik - 422 009.
 Ph.: 0253 - 2328719.

City Office :
 Padmalaxmi Apt., Near Vishwas Bank,
 Savarkar Nagar, Gangapur Road,
 Nashik - 422 013. Ph.: 0253 - 2970142.

- visit us : www.roongtagroup.co.in
- email : roongtagroup@yahoo.co.in

- **Nikhil Roongta : 98227 15651**
- **Akhil Roongta : 98225 71651**

Mobile Apps.:

roongtagroup roongtagroupnsk

Google play App Store



Architect : Sagar Kabre

RCC Consultant : Sanjeev Patel

Legal Advisor : Adv. Vidyulata Tated



Canal Road, Opp. Seren Meadows,
 Near Wisdom High School, Pipeline Road,
 Gangapur Road, Nashik.

Note : Whilst every care has been taken in the preparation of this brochure the promoters reserve every right to make additions, alterations, amendments that may be necessitated from time to time. MAA ADVTG- 9225101311